

Troubleshooting

Flowchart — Fan Motors

Both fan motors do not run at all.

First check for blown No. 15 (7.5 A) and No. 50 (20 A) fuses.

Are fuses OK?

NO

Replace blown No. 15 (7.5 A) or No. 50 (20 A) fuse.

YES

Disconnect the 2-P connector from the radiator fan motor.

Check for continuity the BLK wire terminal between the radiator fan motor and body ground.

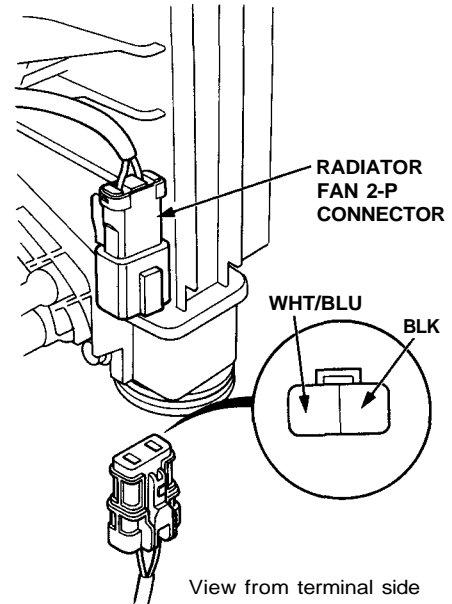

Is there continuity?

NO

Repair open in the BLK wire between the radiator fan motor and body ground. If wire is OK, check for a poor ground at G152.

YES

Remove the condenser fan relay.

Measure voltage between the No. 1 wire terminal of condenser fan relay and body ground.

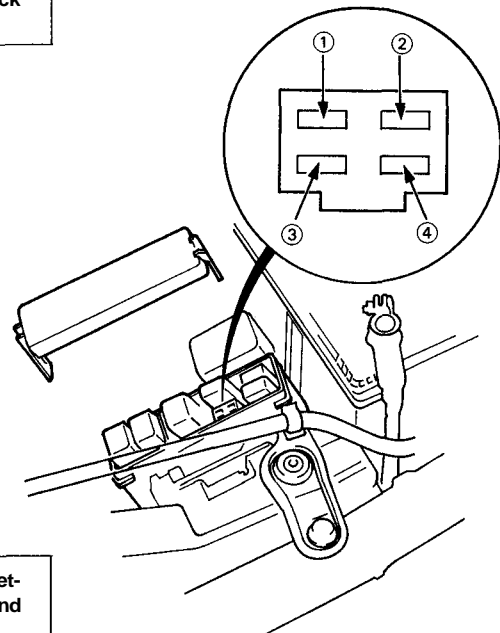

Is there battery voltage?

NO

Repair open in the WHT wire between the No. 50 (20 A) fuse and condenser fan relay.

YES

(To page 22-43)



(From page 22-42)

Test the condenser fan motor. Connect the battery power to the BLU wire terminal and connect the BLK wire terminal to body ground. The condenser fan motor should run.

Is the motor OK?

NO

Replace the condenser fan motor.

YES

Check for continuity on the WHT/BLU wire between the No. ④ terminal of the radiator fan main relay and the radiator fan motor.

View from terminal side

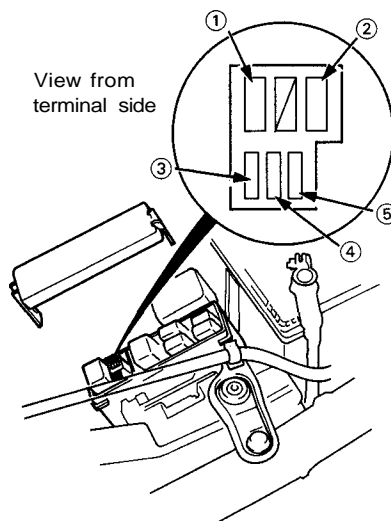

Is there continuity?

NO

Repair open in the WHT/BLU wire between the radiator fan main relay and radiator fan motor.

YES

Test the radiator fan motor. Connect the battery power to the BLU wire terminal and connect the BLK wire terminal to body ground. The radiator fan motor should run.

Is the motor OK?

NO

Replace the radiator fan motor.

YES

(To page 22-44)

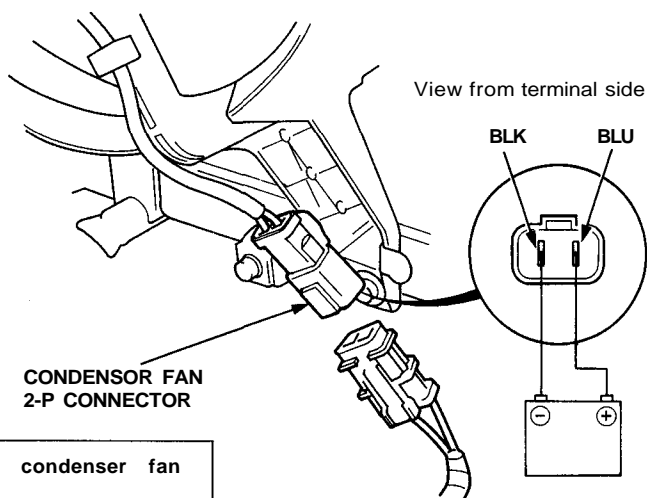

CONDENSER FAN 2-P CONNECTOR

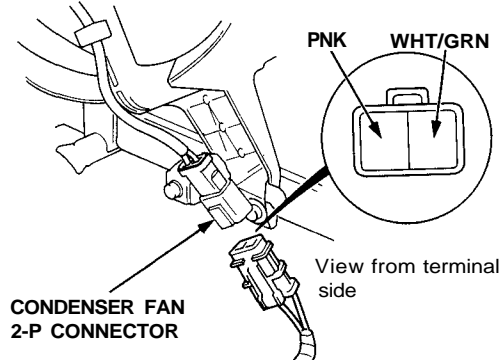

CONDENSER FAN 2-P CONNECTOR

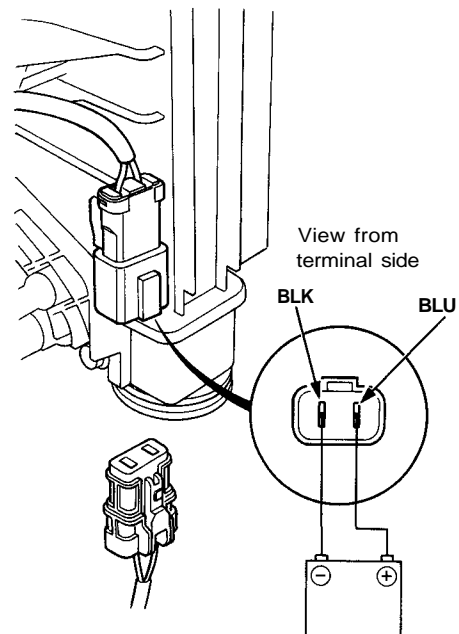

(cont'd)

Troubleshooting

Flowchart — Fan Motors (cont'd)

(From page 22-43)

Disconnect the 2-P connector from condenser fan motor.

Check for continuity on the PNK wire between the No. ③ terminal of the condenser fan relay and the condenser fan motor.

Is there continuity?

YES

Test the condenser fan relay, (see page 21-65)

Is the relay OK?

YES

Remove the radiator fan main relay.

Check for continuity the WHT/CRN wire between the No. ② terminal of the radiator fan main relay and the condenser fan motor.

Is there continuity?

YES

(To page 22-45)

NO

Repair open in the PNK wire between the condenser fan relay and condenser fan motor.

NO

Replace the condenser fan relay.

NO

Repair open in the WHT/GRN wire between the radiator fan main relay and condenser fan motor.

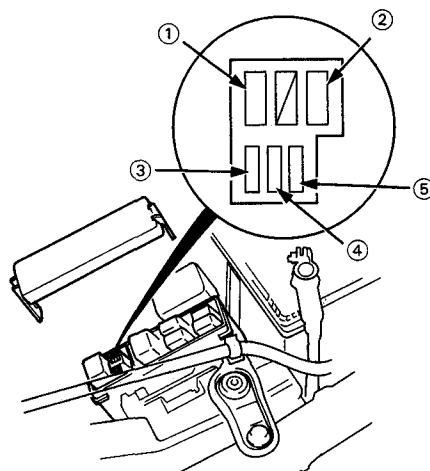
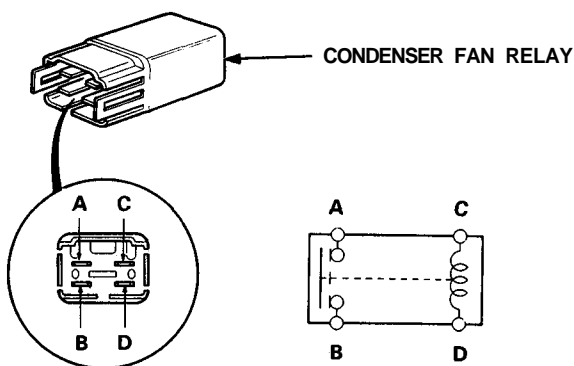
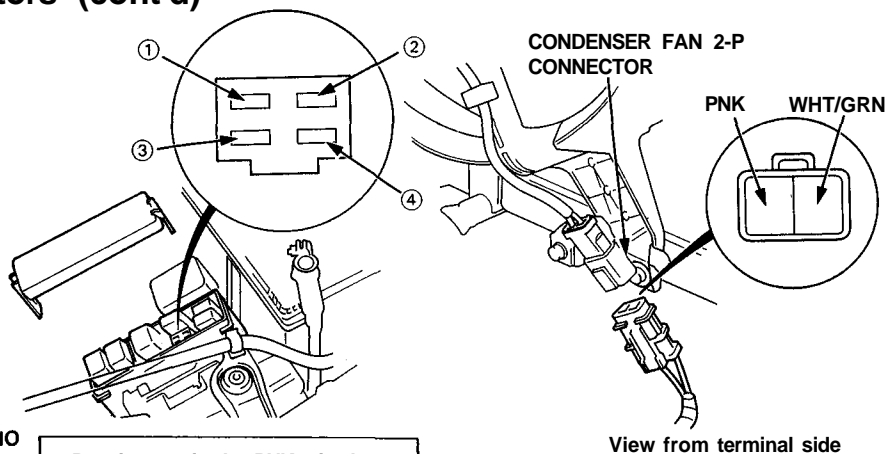

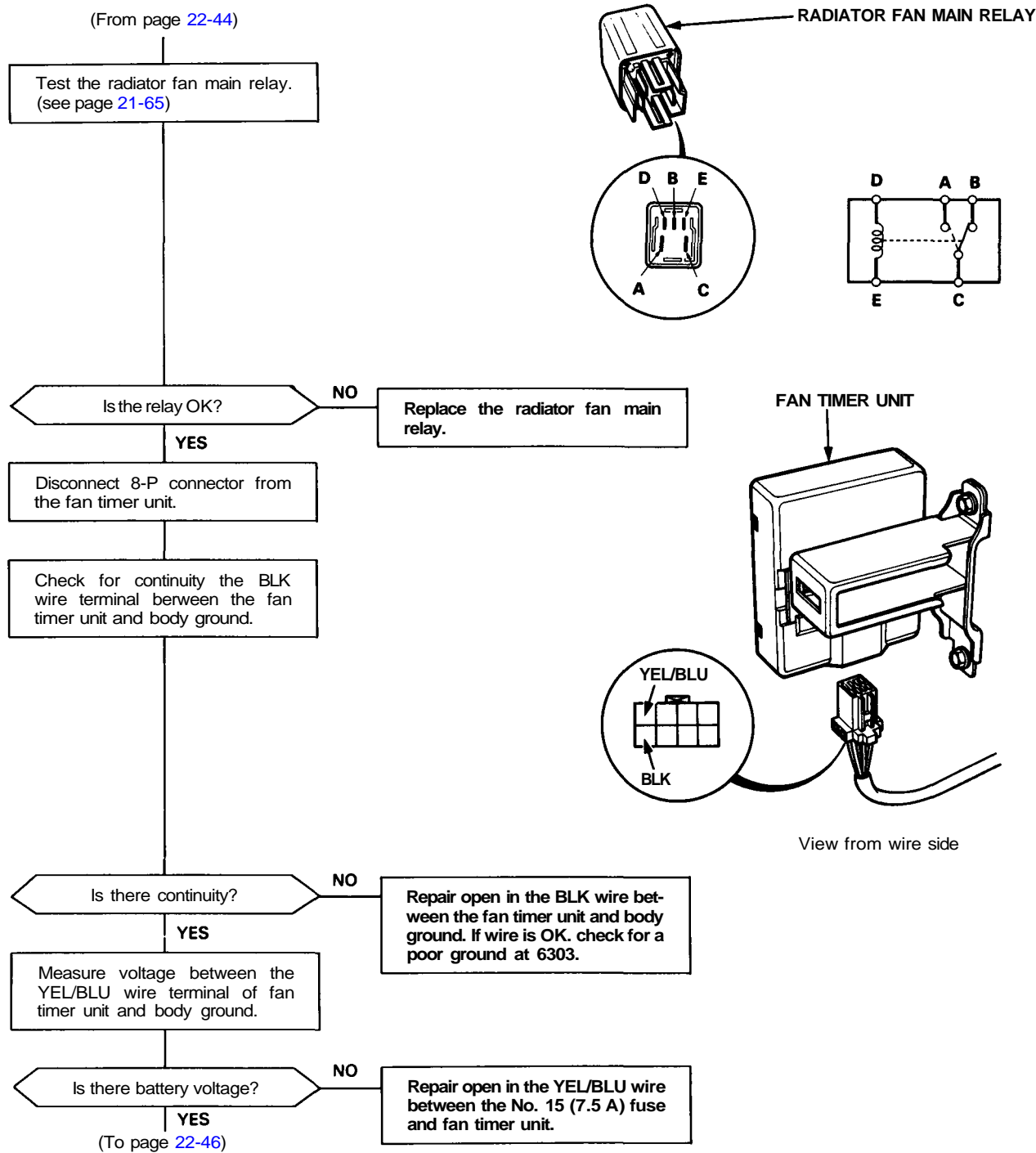

(cont'd)

Troubleshooting

Flowchart — Fan Motors (cont'd)

(From page 22-45)

Check for continuity the GRN wire between the fan timer unit and body ground.

Is there continuity?

YES

Repair short in the GRN wire between the fan timer unit and condenser fan relay.

NO

Using a jumper wire, connect the No. ② terminal of condenser fan relay and body ground.

Check for continuity on the GRN wire between the fan timer unit and body ground.

Is there continuity?

NO

Repair open in the GRN wire between the condenser fan relay and fan timer unit.

YES

Check for continuity on the BLU/RED wire between the No. ② terminal of condenser fan relay and fan timer unit.

Is there continuity?

NO

Repair open in the BLU/RED wire between the condenser fan relay and fan timer unit.

YES

(To page 22-47)

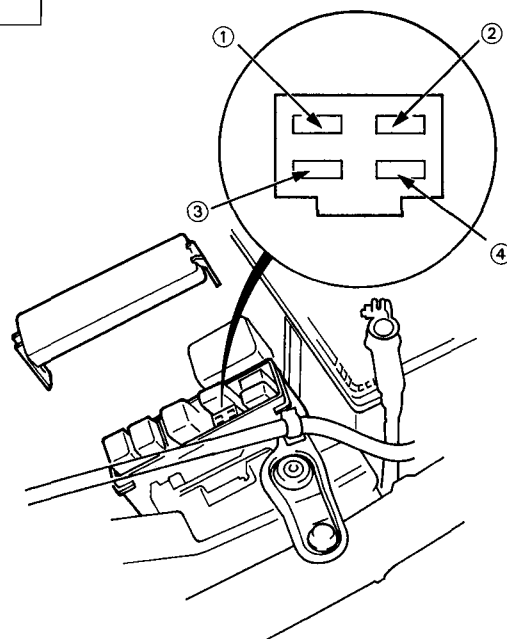
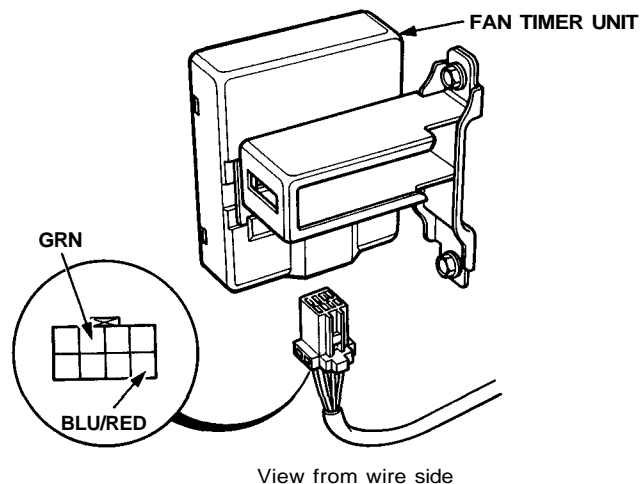

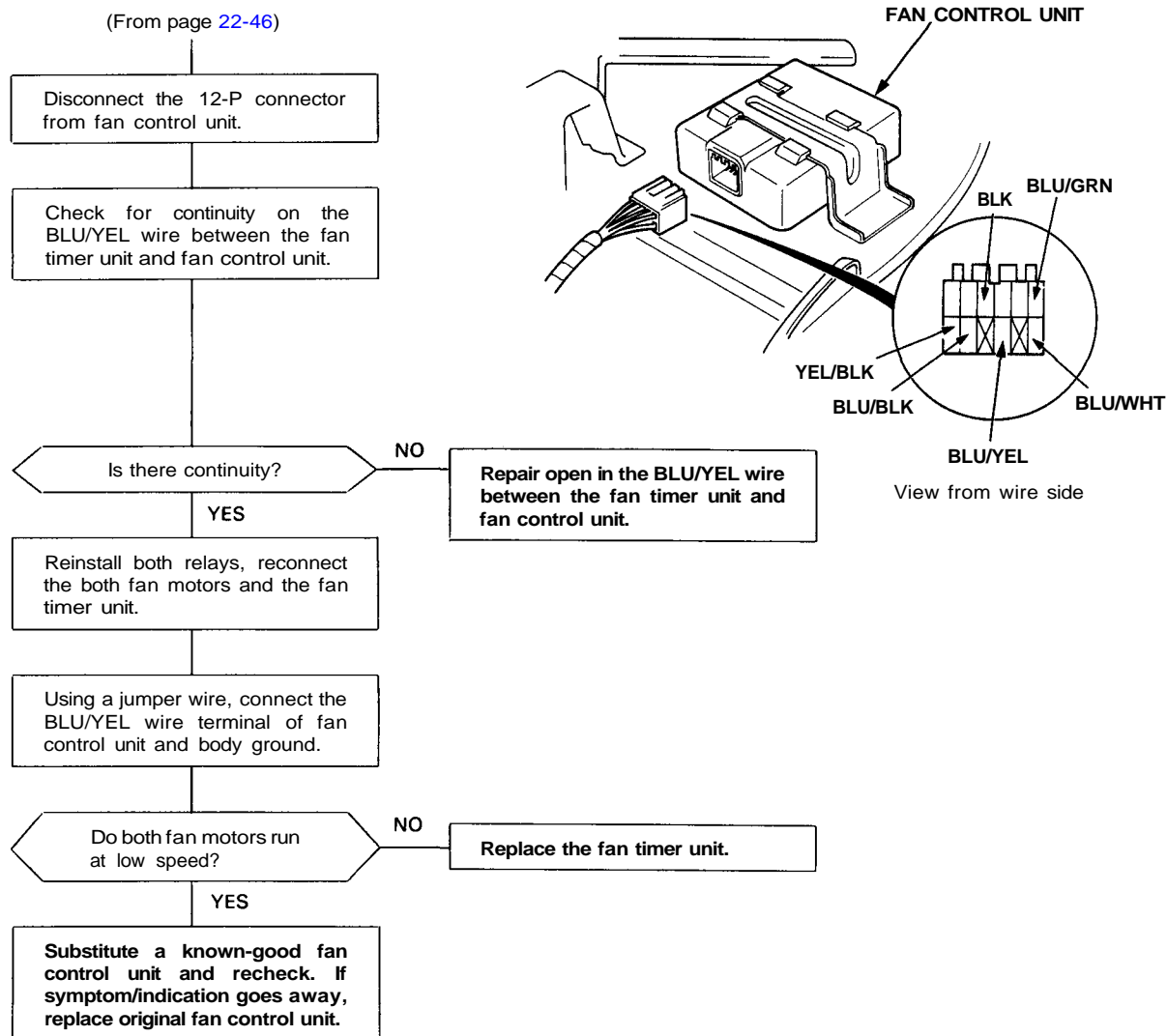

Troubleshooting

Flowchart — Fan Motors(cont'd)

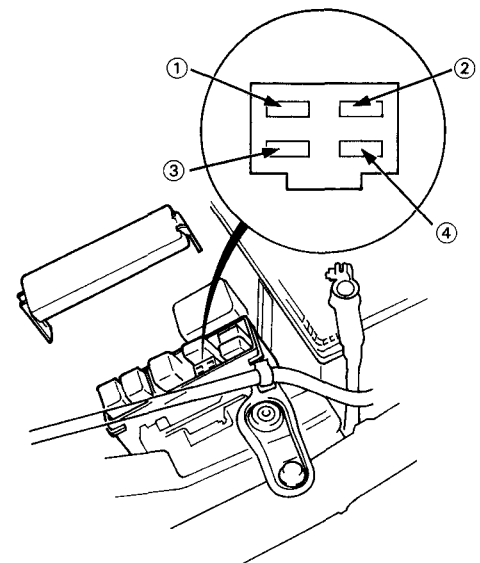
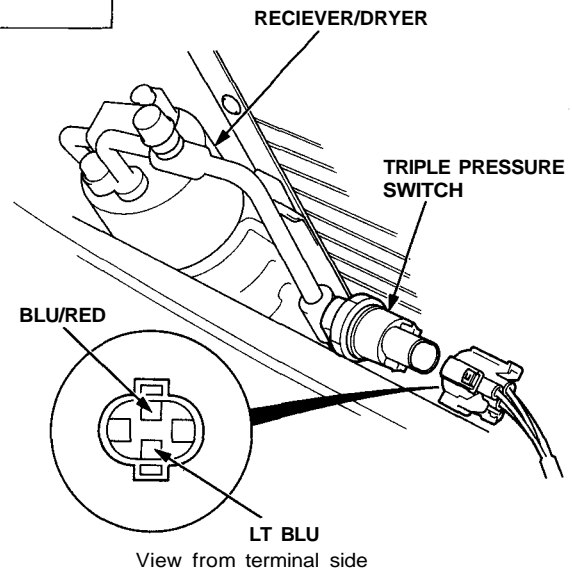
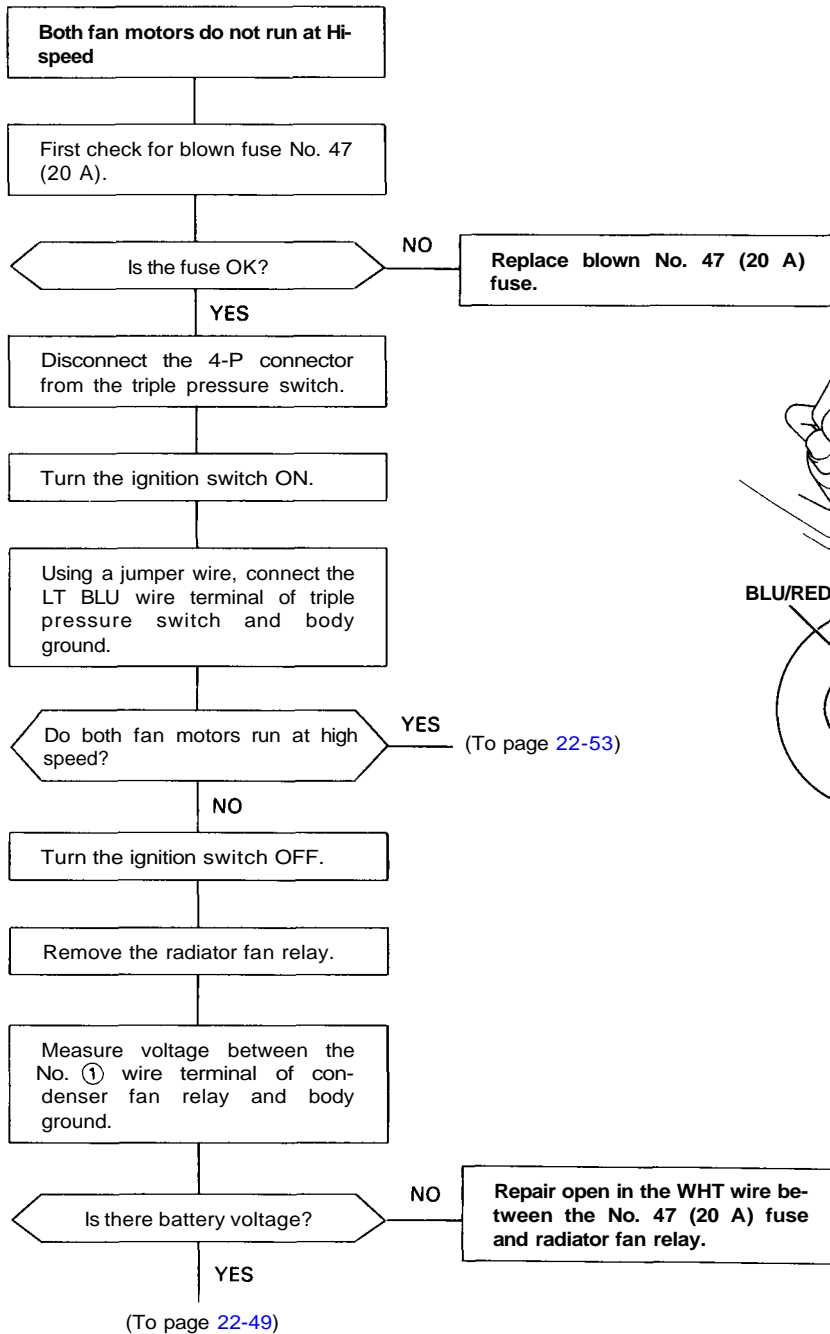



(From page 22-48)

Turn the ignition switch ON.

Measure voltage between the No. ④ wire terminal of radiator fan relay and body ground.

Is there battery voltage?

NO

Repair open in the YEL/BLK wire between the No. 3 (15 A) fuse and radiator fan relay.

YES

Turn the ignition switch OFF.

Test the radiator fan relay. (see page 21-65)

Is the relay OK?

NO

Replace the radiator fan relay.

YES

(To page 22-50)

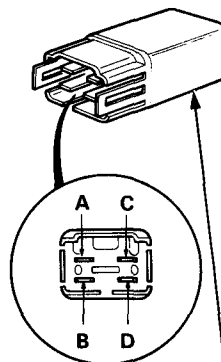
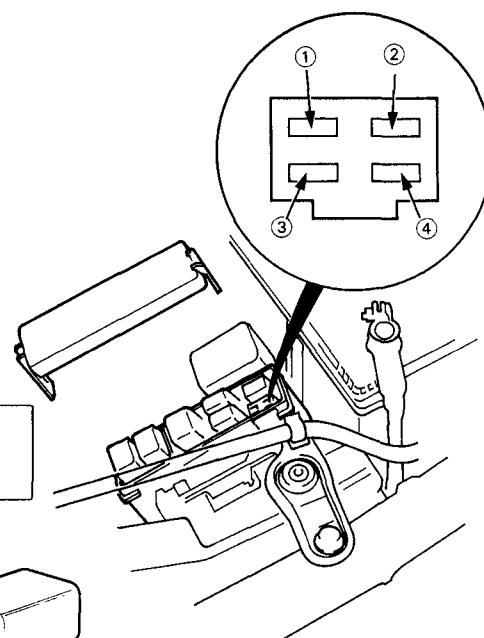

RADIATOR FAN RELAY

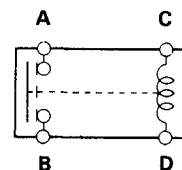

(cont'd)

Trouble shooting

Flowchart — Fan Motors (cont'd)

(From page 22-49)

Disconnect 2-P connector from the radiator fan motor.

Check for continuity on the WHT/BLU wire between the No. ③ terminal of the radiator fan relay and radiator fan motor.

Is there continuity?

NO

Repair open in the WHT/BLU wire between the radiator fan relay and radiator fan motor.

YES

Remove the radiator fan main relay.

Turn the ignition switch ON.

Measure voltage between the No. ⑤ terminal of radiator fan main relay and body ground.

Is there battery voltage?

NO

Repair open in the YEL/BLK wire between the No. 3 (15 A) fuse and radiator fan main relay.

YES

Turn the ignition switch OFF.

(To page 22-51)

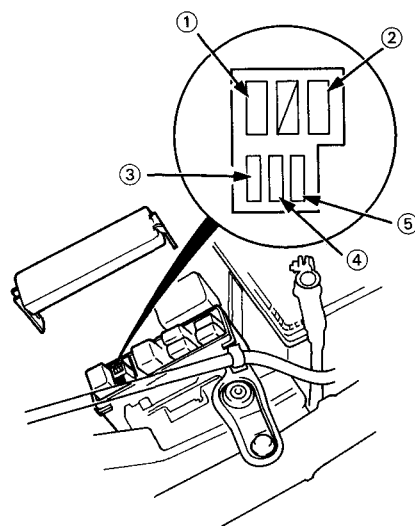
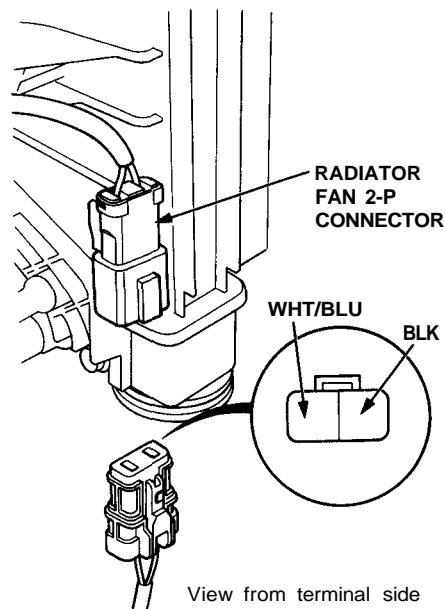
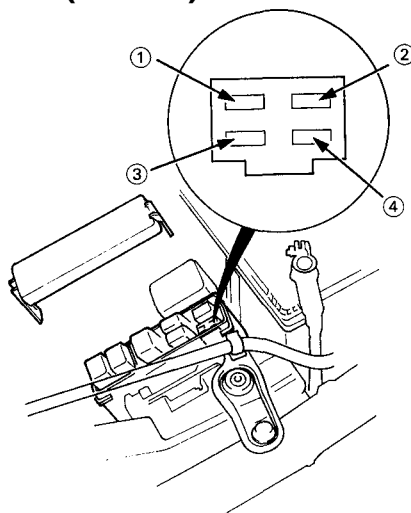



(From page 22-50)

Check for continuity on the BLK wire between the No. ① terminal of the radiator fan main relay and body ground.

Is there continuity?

NO

Repair open in the BLK wire between the radiator fan main relay and body ground at G152.

YES

Test the radiator fan main relay.
(see page 21-65)

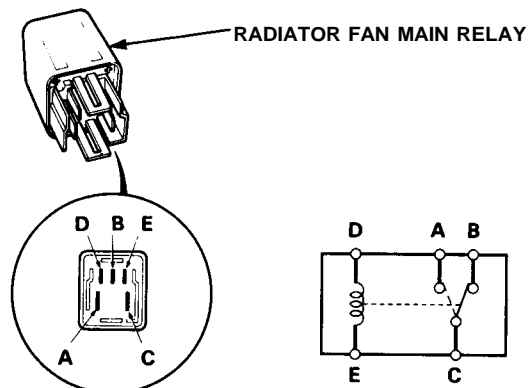

RADIATOR FAN MAIN RELAY

Is the relay OK?

NO

Replace the radiator fan main relay.

YES

Reinstall the radiator fan relay and radiator fan main relay, reconnect the 2-P connector to the radiator fan motor.

(To page 22-52)

(cont'd)

Troubleshooting

Flowchart — Fan Motors (cont'd)

(From page 22-51)

Disconnect the 12-P connector from the fan control unit.

Turn the ignition switch ON.

Using a jumper wire, connect the BLU wire terminal and the BLU/YEL wire terminal of fan control unit and body ground.

Do both fan motors run at high speed?

NO

Repair open in the BLU wire between the radiator fan relay, radiator fan main relay and fan control unit.

YES

Substitute a known-good fan control unit and recheck. If symptom/indication goes away, replace original fan control unit.

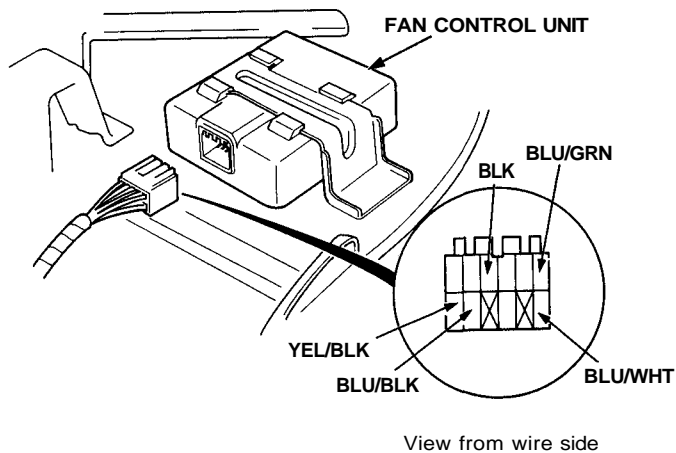

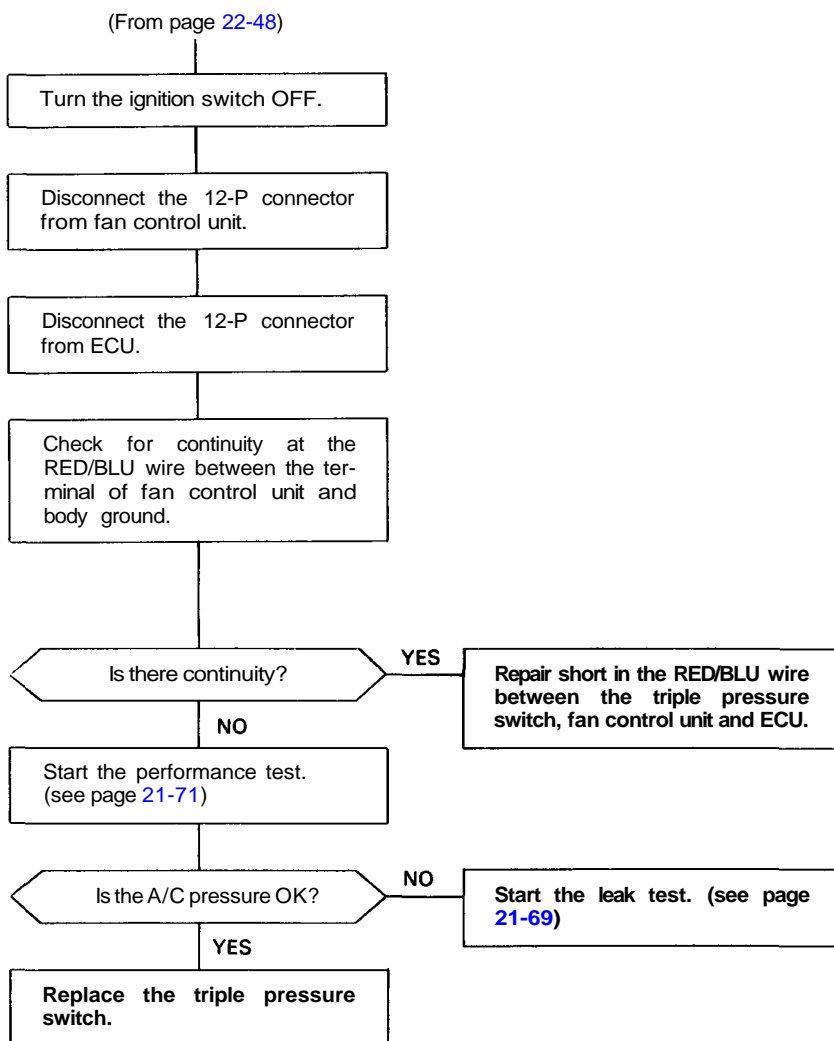

(cont'd)

Troubleshooting

Flowchart — Fan Motors (cont'd)

Both fan motors do not run at low-speed.

Disconnect 4-P connector from the triple pressure switch.

Check for continuity on the BLK wire between the triple pressure switch and body ground.

Is there continuity?

NO

Repair open in the BLK wire between the triple pressure switch and body ground. If wire is OK, check for a poor ground at G153.

YES

Turn the ignition switch ON.

Using a jumper wire, connect the LT BLU wire terminal, the RED/BLU wire terminal of triple pressure switch and body ground.

Do the both fan motors run at low speed?

YES

Turn the ignition switch OFF.

NO

Turn the ignition switch OFF.

Remove the radiator fan main relay.

Disconnect 2-P connector from the radiator fan motor.

(Topage22-55)

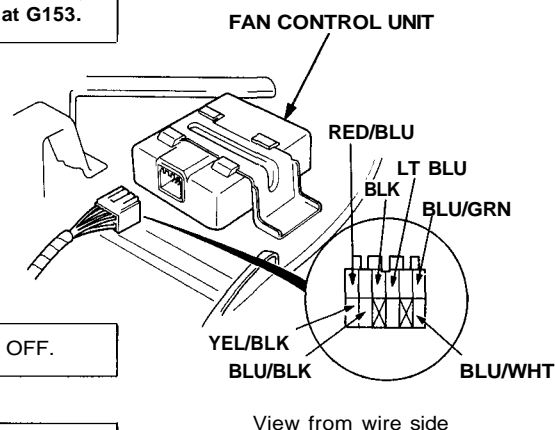
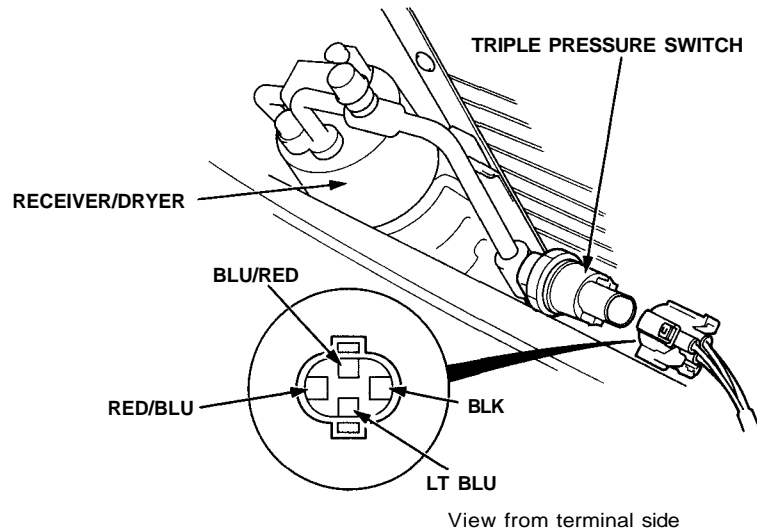

Disconnect the 12-P connector from fan control unit.

Check for continuity on the RED/BLU wire between the triple pressure switch and fan control unit.

Is there continuity?

NO

Repair open in the RED/BLU wire between the triple pressure switch and fan control unit.

YES

Replace the triple pressure switch.

